

High Performance Mono Crystalline SPV Module

Specification			
Model	ESC-36M-80	ESC-36M-85	ESC-36M-90
Cell Size (mm)	125*125	125*125	125*125
No. of Cells (Pcs)	36	36	36
Dimensions (mm)	1200*550*35	1200*550*35	1200*550*35
Solar Cell Efficiency	15.00%	16.00%	17.00%



Electrical Characteristics			
Model	ESC-36M-80	ESC-36M-85	ESC-36M-90
Max Power (Wp)	80	85	90
Max. Power Voltage (Vmp)	17.6	17.8	18
Max. Power Current (Imp)	4.55	4.78	5
Open Circuit Voltage (Voc)	21.2	21.4	21.6
Short Circuit Current (Isc)	5.01	5.26	5.52

Standard Operating Conditions	
Max. System Voltage (V)	1000
Temperature Coeff. of Isc (%)	0.05/°C
Temperature Coeff. of Voc (%)	-0.35/°C
Temperature Coeff. of Pm (%)	-0.45/°C
Temperature Coeff. of Im (%)	+0.1/°C
Temperature Coeff. of Vm (%)	-0.38/°C
Nominal Operating Cell Temperature-NOCT	45 ± 2°C
Temperature Range	-40°C ~ +80°C

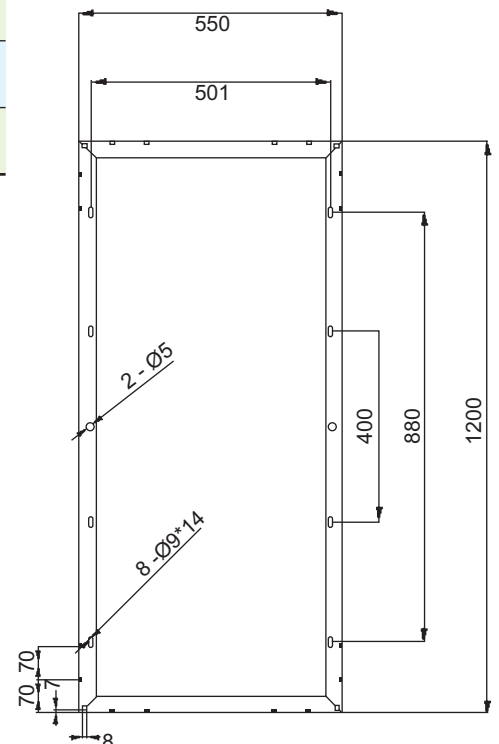



High Performance Mono Crystalline SPV Module

Other Characteristics

Weather Resistance Junction Box Type (TUV Safety Class II)	IP65, TUV Certified
Construction	Superstrate: High Transmission 3.2mm Tempered Low Iron Glass Substrate: White Back Sheet; Encapsulant: Fast Cure EVA
Frame	Clear anodized aluminium alloy; Color: Silver
Watt Tolerance	± 5%
Module Efficiency	13.65% / 14.50% / 15.60%
Weight	8.5 kg
Product Certifications	IEC 61215, IEC 61730 & CE



Characteristics

Module I-V Graph 80W / 85W / 90W

I-V Curves of ESC-36M-80 / 85 / 90 at different Irradiance
Cell Temp. : 25° C

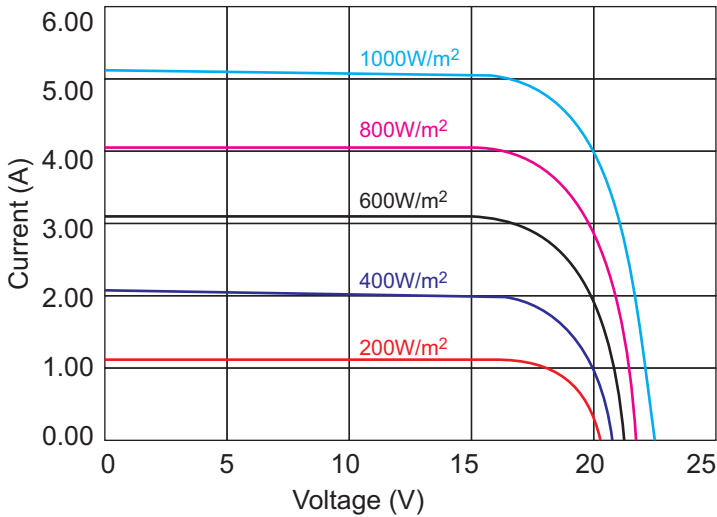

I-V Curves of ESC-36M-80 / 85 / 90 at different Cell Temperature
IRRADIANCE: AM 1.5 1000W/m²

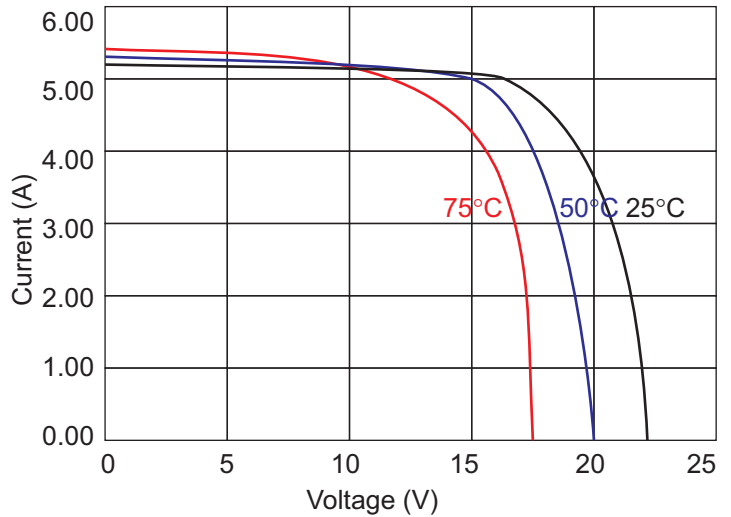

Warranty

- 2 years warranty against manufacturing defects
- 10 years warranty at 90% rated performance
- 20 years warranty at 80% rated performance

Note: This publication summarizes product warranty and specification, which are subject to change without prior notice.